

STIHL KB-KM, KW-KM

Instruction Manual



Contents

| | |
|---|----|
| KombiSystem | 2 |
| Guide to Using this Manual | 2 |
| Safety Precautions and Working Techniques | 2 |
| Using the Unit | 5 |
| Approved KombiEngines | 7 |
| Assembling the Unit | 8 |
| Mounting the KombiTool | 9 |
| Fitting the Harness | 10 |
| Balancing the Machine | 11 |
| Starting / Stopping the Engine | 11 |
| Storing the Machine | 12 |
| Replacing the Sweeping Attachments | 12 |
| Maintenance and Care | 13 |
| Minimize Wear and Avoid Damage | 13 |
| Main Parts | 15 |
| Specifications | 16 |
| Maintenance and Repairs | 17 |
| Disposal | 17 |
| EC Declaration of Conformity | 18 |

STIHL®

KB-KM, KW-KM

Dear Customer,

Thank you for choosing a quality engineered STIHL product.

It has been built using modern production techniques and comprehensive quality assurance. Every effort has been made to ensure your satisfaction and trouble-free use of the product.

Please contact your dealer or our sales company if you have any queries concerning this product.

Your



Dr. Nikolas Stihl

KombiSystem

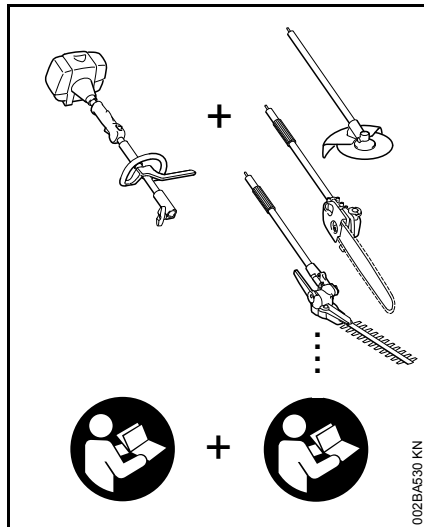

In the STIHL KombiSystem a number of different KombiEngines and KombiTools can be combined to produce a power tool. In this instruction manual the functional unit formed by the KombiEngine **and** KombiTool is referred to as the power tool.

Therefore, the separate instruction manuals for the KombiEngine and KombiTool should be used together for the power tool.

Always read and and make sure you understand **both** instruction manuals before using your power tool for the first time and keep them in a safe place for future reference.

Guide to Using this Manual

Pictograms

All the pictograms attached to the machine are shown and explained in this manual.

Symbols in text



WARNING

Warning where there is a risk of an accident or personal injury or serious damage to property.



NOTICE

Caution where there is a risk of damaging the machine or its individual components.

Engineering improvements

STIHL's philosophy is to continually improve all of its products. For this reason we may modify the design, engineering and appearance of our products periodically.

Therefore, some changes, modifications and improvements may not be covered in this manual.

Safety Precautions and Working Techniques



Special safety precautions must be observed when working with the PowerSweep and bristle brush.



Always read and make sure you understand both instruction manuals (KombiEngine and KombiTool) before using your power tool for the first time and keep them in a safe place for future reference. Non-observance of the safety precautions may result in serious or even fatal injury.

Lend or rent your power tool only to persons who are familiar with this model and its operation – do not lend or rent your power tool without the KombiEngine and KombiTool instruction manuals.

Use the bristle brush only for sweeping areas and paths, including uneven and jointed surfaces, and natural stone paving.

Use the PowerSweep only for sweeping areas and paths, moving wet materials, such a leaves or dirt to a central point, clearing snow and removing standing water from solid surfaces.

Do not use your power tool for any other purpose because of the **increased risk of accidents**.

Only mount accessories that are explicitly approved for this power tool model by STIHL or are technically identical. If you have any questions in this respect, consult a servicing dealer.

Use only high quality tools and accessories in order to avoid the risk of accidents and damage to the machine.

STIHL recommends the use of genuine STIHL tools and accessories. They are specifically designed to match the product and meet your performance requirements.

Never attempt to modify your power tool in any way since this may increase the risk of personal injury. STIHL excludes all liability for personal injury and damage to property caused while using unauthorized attachments.

Do not use a pressure washer to clean the unit. The solid jet of water may damage parts of the unit.

Clothing and Equipment

Wear proper protective clothing and equipment.



Clothing must be sturdy but allow complete freedom of movement. Wear snug-fitting clothing, an overall and jacket combination, do not wear a work coat.

Avoid clothing that could get caught on branches or brush or moving parts of the machine. Do not wear a scarf, necktie or jewelry. Tie up and confine long hair (e.g. with a hair net, cap, hard hat, etc.).



Wear sturdy shoes with non-slip soles.



WARNING



To reduce the risk of eye injuries, wear snug-fitting safety glasses in accordance with European Standard EN 166. Make sure the safety glasses are a good fit.

Wear hearing protection, e.g. earplugs or ear muffs.



Wear heavy-duty work gloves made of durable material (e.g. leather).

STIHL offers a comprehensive range of personal protective clothing and equipment.

Transporting the Power Tool

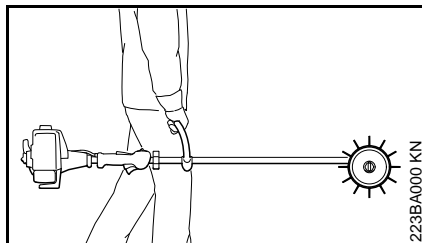

Always turn off the engine.

Carry the machine by the carrying handle, sweeping attachment in front of you, hot muffler away from your body.

Transporting by vehicle: Properly secure your power tool to prevent turnover, fuel spillage and damage.

Before Starting

Check that your power tool is properly assembled and in good condition – refer to appropriate chapters in the KombiEngine and KombiTool instruction manuals.

- Check the attachment for correct and secure assembly and good condition.
- Both sweeping attachments must be mounted.
- Never attempt to modify the controls or safety devices in any way.
- Inspect the deflectors for damage and wear. Do not operate the machine with a damaged deflector – replace damaged parts.
- Keep the handles dry and clean – free from oil and dirt – for safe control of the power tool.
- Adjust shoulder strap and handles to suit your height and reach. See chapter on "Fitting the Harness".

To reduce the risk of accidents, do not operate your power tool if it is damaged or not properly assembled.

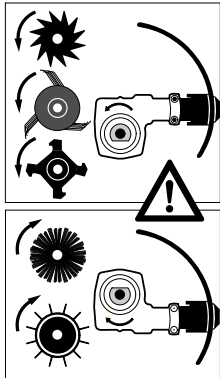

If you use sweeping attachments, position the gearbox so that the axle is above the drive shaft.

If you use a shoulder strap or full harness: Practice removing and putting down the power tool as you would in an emergency. To avoid damage, do not throw the machine to the ground when practicing.

Replace damaged sweeping attachments.

See also notes on "Before Starting" in the instruction manual of the KombiEngine you are using.

Holding and Controlling the Power Tool

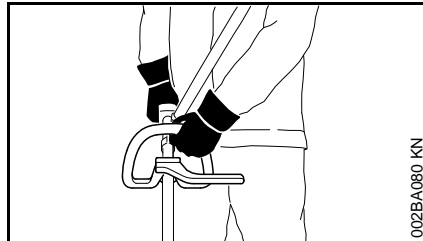

Make sure you always have good balance and secure footing.

Always hold the power tool firmly with both hands on the handles.

Right hand on control handle, left hand on loop handle, even if you are left-handed.

To ensure safe control, wrap your fingers tightly around the front handle and control handle.

During Operation

In the event of impending danger or in an emergency, switch off the engine immediately by moving the slide control / stop switch/button to **0** or **STOP**.

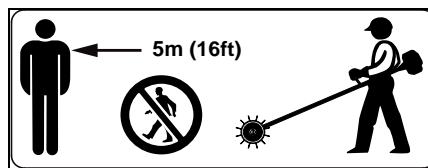

To reduce the risk of injury from thrown objects, do not allow any other persons within a radius of 5 meters of your own position. **To reduce the risk of damage to property**, also maintain this distance from other objects (vehicles, windows).

The correct engine idle speed is important to ensure that the attachment stops moving when you let go of the throttle trigger. Check and correct the idle speed setting regularly. If the attachment still rotates when the engine is idling, have your dealer check your machine and make proper adjustments or repairs – see KombiEngine instruction manual.

Electrostatic charges may build up when working on synthetic surfaces – **risk of electric shock and accidents**.

Take special care in slippery conditions (ice, wet ground, snow), on slopes or uneven ground.

Watch out for obstacles: Roots and tree stumps which **could cause you to trip or stumble**.

Make sure you always have good balance and secure footing.

Be particularly alert and cautious when wearing hearing protection because your ability to hear warnings (shouts, alarms, etc.) is restricted.

To reduce the risk of accidents, take a break in good time to avoid tiredness or exhaustion.

Work calmly and carefully – in daylight conditions and only when visibility is good. Stay alert so as not to endanger others.



The dusts, vapor and smoke produced during operation may be dangerous to health. If dust levels are high, wear a suitable respirator.

To reduce the risk of a dust explosion, spray very dusty surfaces with water before sweeping.

If your power tool is subjected to unusually high loads for which it was not designed (e.g. heavy impact or a fall), always check that it is in good condition before continuing work – see also "Before Starting". Make sure the safety devices are working properly. Do not continue operating your power tool if it is damaged. In case of doubt, consult your servicing dealer.

To reduce the risk of injury from thrown objects, never operate the unit without a properly mounted deflector designed specifically for the unit and the attachment.



Inspect the work area: Stones, pieces of metal or other solid objects **may be thrown and cause personal injury**

Special care must be taken when working in overgrown terrain.

When clearing leaves, take care not to harm small animals.

Check the sweeping attachments at regular short intervals during operation or immediately if there is a sudden change in behavior:

- Shut off the engine, hold the unit securely.
- Check condition and proper mounting.
- Replace damaged sweeping attachments immediately.

Before leaving the power tool unattended: Shut off the engine.

Regularly clean the attachment mounting and remove any blockages and material that has accumulated between the sweeping attachments or around the deflector.

To reduce the risk of injury, shut off the engine before changing attachments.

Maintenance and Repairs

Only carry out the maintenance operations and repairs described in the KB-KM, KW-KM KombiTool and KombiEngine instruction manuals. All other repairs must be performed by an authorized STIHL service shop.

Only use original STIHL replacement parts for maintenance and repairs. Using replacement parts from other manufacturers may result in damage to the machine or personal injury.

Never attempt to modify the sweeping attachments in any way. You may be putting your own safety at risk.

Shut off the engine

- before carrying out any maintenance or repair work
- before removing and installing sweeping attachments
- before rectifying problems.

Store the power tool as described in the instruction manuals – see chapter on "Storing the Machine".

Using the Unit

Sweeping Attachments

KombiTools for sweeping and cleaning operations are available in two versions: KB-KM bristle brush and KW-KM PowerSweep.

Preparations

If the surface to be cleaned is dry, spray it with water to reduce the amount of dust created.

- To reduce the risk of accidents or injury, remove all obstacles and objects from the work area.
- Start the engine.
- Put on the shoulder strap.

The KombiEngine with sweeping attachment is operated in the forward direction only.

Working Technique

Bristle Brush



The the KB-KM KombiTool bristle brush is used for cleaning areas and paths, including uneven and jointed surfaces, and natural stone paving.

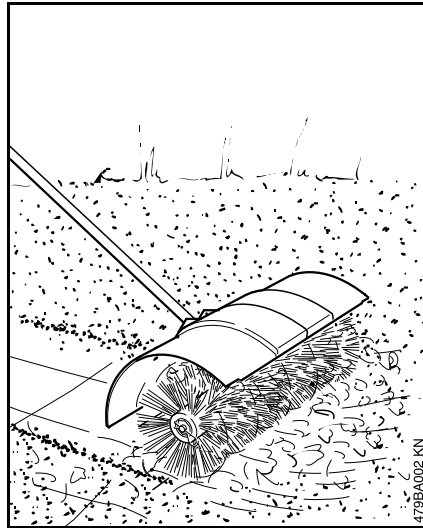

! WARNING

To reduce the risk of injury, never work without the properly mounted deflector and two extensions.

These devices divert material away from the machine and the operator.

- Push the bristle brush steadily at walking pace.

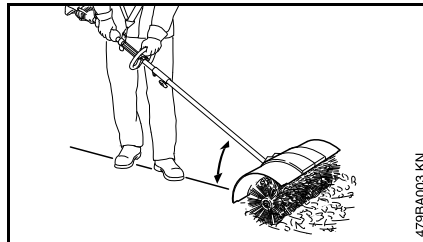

- Always hold and guide the tool at a shallow angle.

! WARNING

The steeper the angle shown above, the more difficult it is to control the tool.

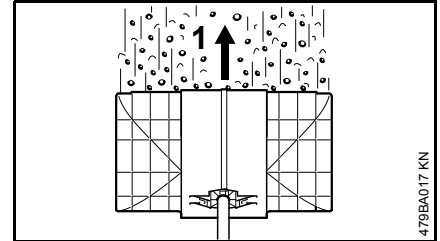

- Guide the bristle brush at right angles to the direction of travel (1). Sweepings are thrown forwards, ahead of the operator.

! WARNING

The bristle brush pushes back towards the operator.

PowerSweep

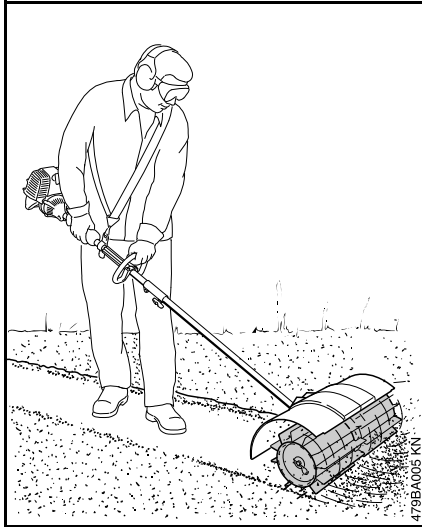

The KW-KM PowerSweep KombiTool is used for sweeping areas and paths, moving wet materials, such as leaves or dirt to a central point, clearing snow and removing standing water from solid surfaces.

- Push the PowerSweep steadily at walking pace.

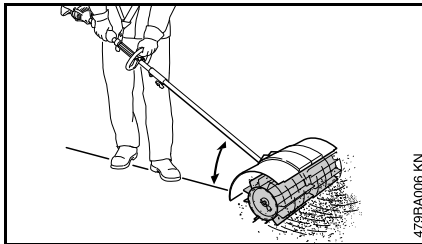

- Always hold and guide the tool at a shallow angle.

! WARNING

The steeper the angle shown above, the more difficult it is to control the tool.

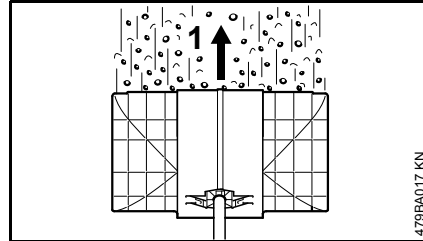

- Guide the PowerSweep at right angles to the direction of travel (1). Sweepings are thrown forwards, ahead of the operator.

! WARNING

The PowerSweep pushes back towards the operator.

Cleaning the Sweeping Attachment

Clean away any dirt and debris that has accumulated between the sweeping attachments, around the gearbox or between the sweeping attachments and the deflector:

- Shut off the engine.
- Pull the hitch pins out of the axle.
- Remove the sweeping attachments from the axle and clean them.
- Clean away dirt and debris from the machine.

Refit the sweeping attachments – see “Replacing the Sweeping Attachments”.

Approved KombiEngines

Only use KombiEngines supplied by STIHL or expressly approved by STIHL for use with the KombiTool.

This KombiTool may be operated only in combination with the following KombiEngines:

STIHL KM 55 R, KM 56 R, KM 85 R¹⁾,
KM 90 R, KM 94 R, KM 100 R,
KM 110 R¹⁾, KM 130 R

! WARNING

Loop-handled machines must be equipped with a barrier bar.

¹⁾ outside the EU only

Assembling the Unit

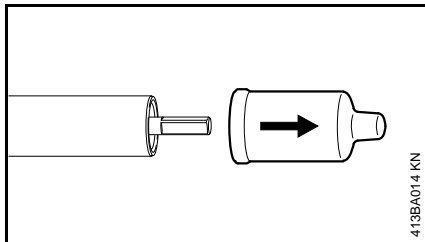

- Pull the protective caps off the ends of the drive tube and keep them in a safe place for later use – see "Storing the Machine".

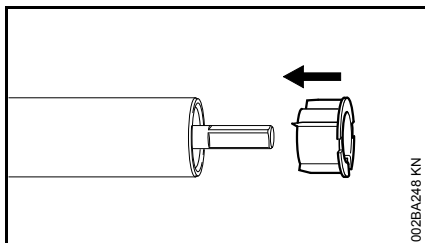

NOTICE

The plug may come out of the drive tube when you pull off the cap. Push it back into the drive tube as far as stop.

Mounting the Deflector

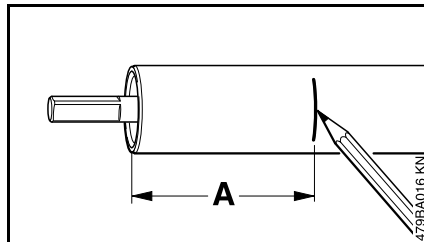

- Apply a mark at distance A (125 mm) from the end of the drive tube.

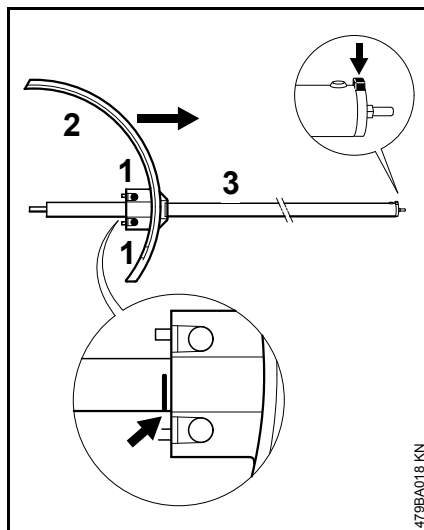

- Loosen the clamp screws (1) and push the deflector (2) onto the drive tube (3) and beyond the mark

(arrow). Then pull the deflector back until it is flush with or just covers the mark (arrow).

- Line up the deflector so that it is vertical and the fixing lug (arrow) on the drive tube points up (upper magnified arrow).
- Tighten down the clamp screws (1) **firmly**.

WARNING

Check that the deflector is secure – it must not be possible to rotate it on the drive tube.

Mounting the Gearbox

- Remove both sweeping attachments – see "Replacing the Sweeping Attachments".

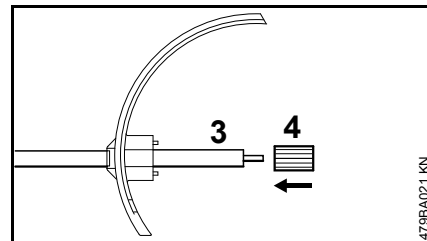

- Push the sleeve (4) onto the drive tube (3) as far as stop.

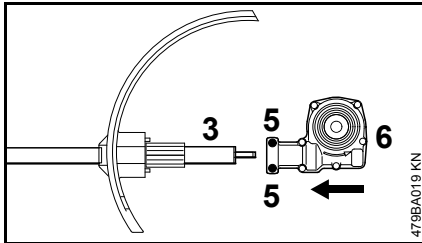

- Loosen the clamp screws (5).
- Push the gearbox (6) onto the drive tube (3), turn the gearbox back and forth as necessary.

Aligning the Gearbox

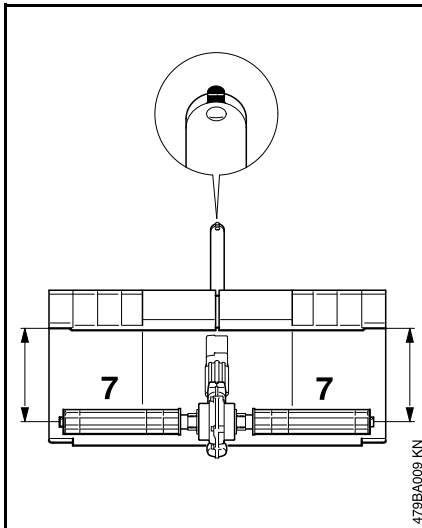

- Line up the gearbox on the drive tube so that the distance between the horizontal axes (7) and the deflector is the same at both sides.
- Tighten down the clamp screws **firmly**.

! WARNING

It must not be possible to rotate the gearbox on the drive tube.

- Mount the two sweeping attachments – see "Replacing the Sweeping Attachments".

Mounting the KombiTool

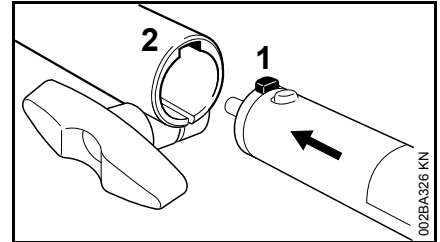

- Push the lug (1) on the drive tube into the slot (2) in the coupling sleeve as far as stop.

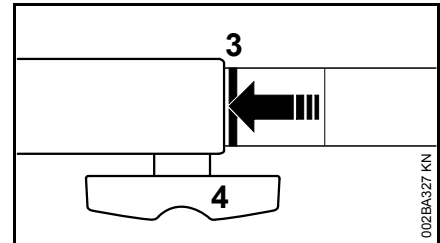

When correctly installed, the red line (3) (arrow point) must be flush with the end of the coupling sleeve.

- Tighten down the star knob (4) **firmly**.

Removing the KombiTool

- Reverse the above sequence to remove the drive tube.

Fitting the Harness

The type and style of the harness and carabiner (spring hook) depend on the market.

Shoulder Strap

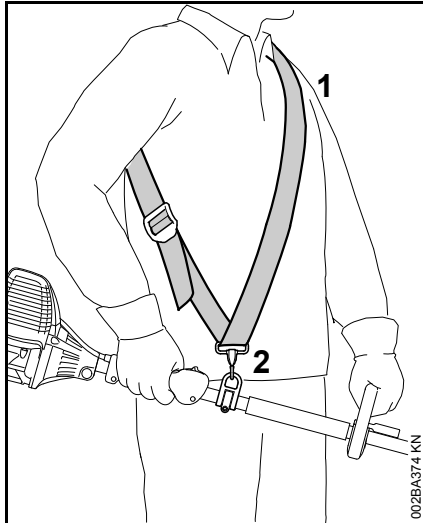

- Put on the shoulder strap (1).
- Adjust the length of the strap so that the carabiner (2) is about a hand's width below your right hip.
- Balance the machine – see "Balancing the Machine".

Full Harness

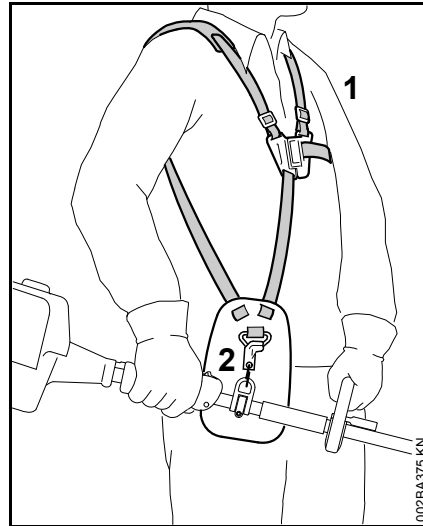

- Put on the full harness (1).
- Adjust the length of the strap so that the carabiner (2) is about a hand's width below your right hip.
- Balance the machine – see "Balancing the Machine".

Attaching Machine to Harness

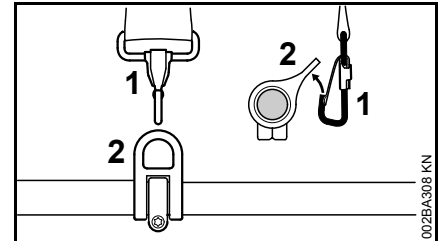

- Attach the carabiner (1) to the carrying ring (2) on the drive tube – hold the carrying ring steady.

Disconnecting Machine from Harness

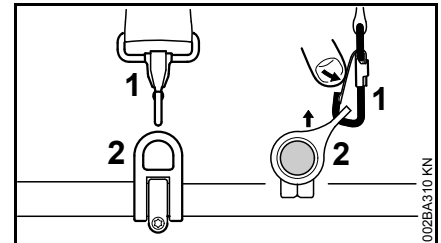

- Press down the bar on the carabiner (1) and pull the carrying ring (2) out of the carabiner.

Throwing Off the Machine

WARNING

The machine must be quickly thrown off in the event of imminent danger. Practice removing and putting down the machine as you would in an emergency. To avoid damage, do not throw the machine to the ground when practicing.

Practice quickly detaching the power tool from the carabiner as described under "Disconnecting Machine from Harness".

If you are using a shoulder strap:
Practice slipping the strap off your shoulder.

If you are using a full harness: Practice quickly opening the locking plate and slipping the harness straps off your shoulders.

Balancing the Machine

Balancing the Machine

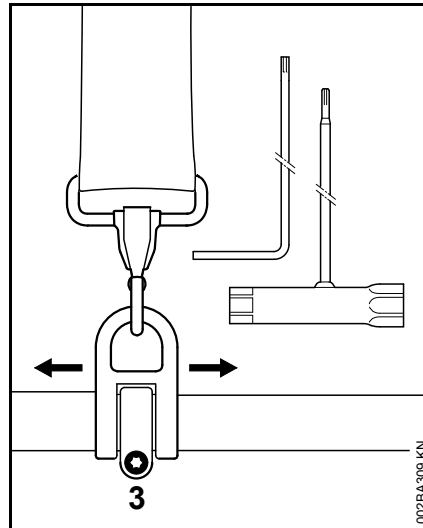

- Loosen the screw (3).

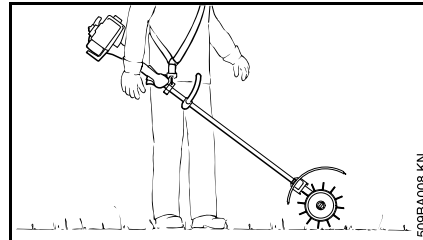

- Slide the carrying ring up or down the drive tube until the sweeping attachments touch the ground.
- Tighten down the screw on the carrying ring firmly.

Starting / Stopping the Engine

Starting the Engine

Always follow the operating instructions for the KombiEngine and basic power tool.

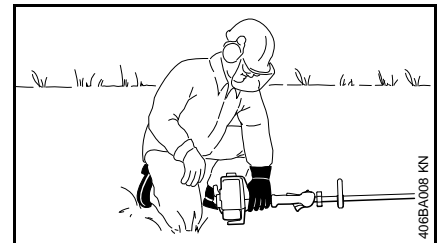
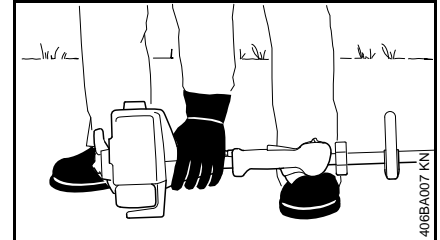

- Place the unit on the ground.

The sweeping attachments may touch the ground, but no other obstacles – **risk of accidents**.

- Make sure you have a firm footing, either standing, stooping or kneeling.
- Hold the machine with you left hand and press it down **firmly** – do not touch the controls on the control handle – see KombiEngine or basic power tool instruction manual.



Do not stand or kneel on the drive tube.

WARNING

The sweeping attachments may begin to rotate and cause the machine to move as soon as the engine starts. For this reason, blip the throttle after starting – the engine returns to idling speed.

The starting procedure is now as described in the instruction manual of the KombiEngine or basic power tool you are using.

Stopping the Engine

- See instruction manual of the KombiEngine or basic power tool.

Storing the Machine

For periods of 3 months or longer

- Remove and clean the sweeping attachments, inspect them for damage and wear.
- If the KombiTool is removed from the KombiEngine and stored separately: Fit the protective cap on the drive tube to avoid dirt getting into the coupling.
- Store the machine in a dry, high or locked location – out of the reach of children and other unauthorized persons.

Replacing the Sweeping Attachments

Bristle Brush

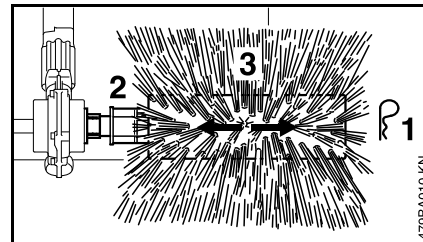

Removing

- Remove the hitch pin (1) from the end of the axle (2).
- Pull the bristle brush (3) off the axle.

Installing

- Push the bristle brush (3) onto the axle.
- Insert the hitch pin (1) in the hole at the end of the axle and fold it flat.
- Use the same procedure to mount the other bristle brush.

WARNING

Always mount both bristle brushes.

PowerSweep

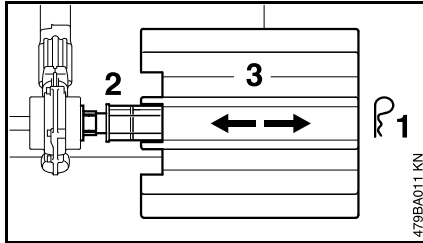

Removing

- Remove the hitch pin (1) from the end of the axle (2).
- Pull the sweeper drum (3) off the axle.

Installing

- Push the sweeper drum (3) onto the axle.
- Insert the hitch pin (1) in the hole at the end of the axle and fold it flat.
- Use the same procedure to mount the other sweeper drum.

WARNING

Always mount both sweeper drums.

Maintenance and Care

The following intervals apply to normal operating conditions only. If your daily working time is longer or operating conditions are difficult (very dusty work area, etc.), shorten the specified intervals accordingly.

All accessible screws and nuts

- Retighten if necessary

Sweeping attachments and deflectors

- Visual inspection, check tightness before starting work and after every refueling stop
- Replace if damaged

Safety labels

- Replace illegible safety labels

Minimize Wear and Avoid Damage

Observing the instructions in this manual and the KombiEngine manual helps reduce the risk of unnecessary wear and damage to the power tool.

The power tool must be operated, maintained and stored with the due care and attention described in these instruction manuals.

The user is responsible for all damage caused by non-observance of the safety precautions, operating and maintenance instructions. This includes in particular:

- Alterations or modifications to the product not approved by STIHL.
- Using tools or accessories which are neither approved or suitable for the product or are of a poor quality.
- Using the product for purposes for which it was not designed.
- Using the product for sports or competitive events.
- Consequential damage caused by continuing to use the product with defective components.

Maintenance Work

All the operations described in the chapter on "Maintenance and Care" must be performed on a regular basis. If these maintenance operations cannot be performed by the owner, they should be performed by a servicing dealer.

STIHL recommends that you have servicing and repair work carried out exclusively by an authorized STIHL

servicing dealer. STIHL dealers are regularly given the opportunity to attend training courses and are supplied with the necessary technical information.

If these maintenance operations are not carried out as specified, the user assumes responsibility for any damage that may occur. Among other parts, this includes:

- Corrosion and other consequential damage resulting from improper storage.
- Damage to the product resulting from the use of poor quality replacement parts.

Parts Subject to Wear and Tear

Some parts of the power tool are subject to normal wear and tear even during regular operation in accordance with instructions and, depending on the type and duration of use, have to be replaced in good time. Among other parts, this includes:

- Sweeping attachment (roller brushes, sweeper belts)
- Deflector, deflector extension

Main Parts

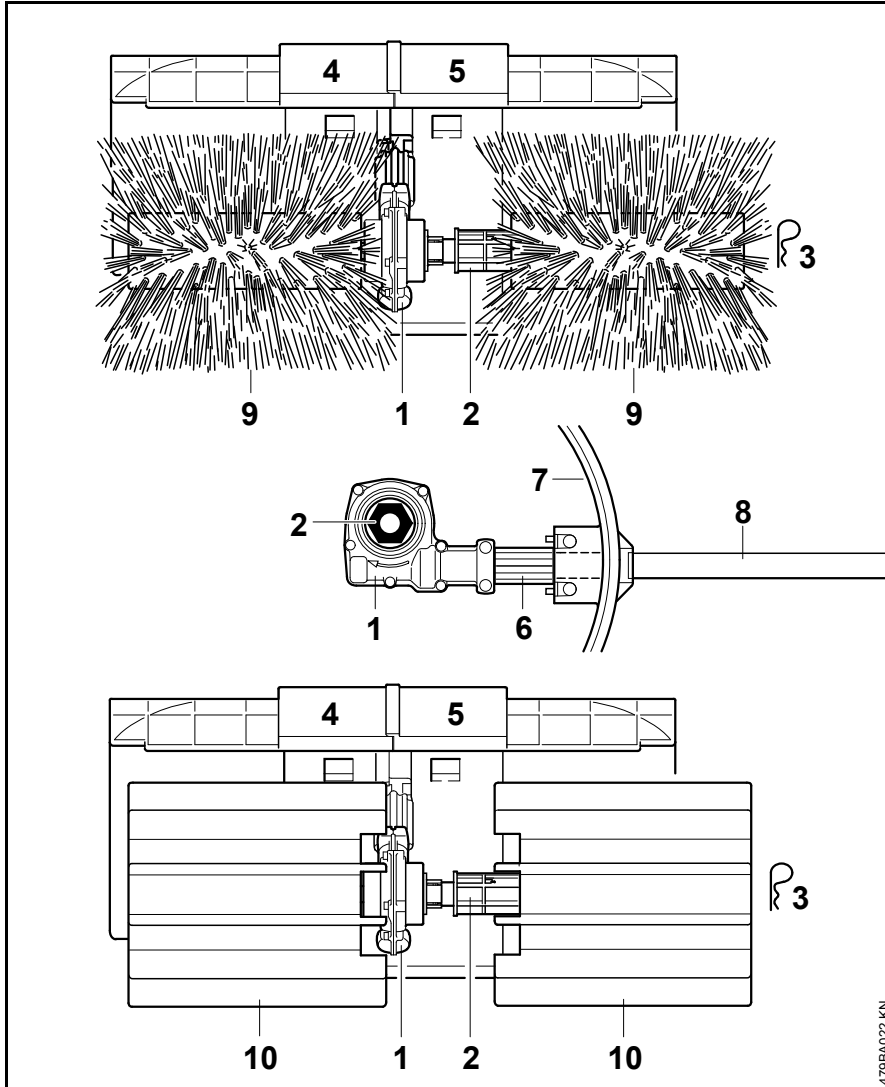
**Bristle Brush, PowerSweep**

- 1 Gearbox
- 2 Axle
- 3 Hitch pin
- 4 Deflector extension, right
- 5 Deflector extension, left
- 6 Sleeve
- 7 Deflector
- 8 Drive tube

Bristle Brush

- 9 Roller brush

PowerSweep

- 10 PowerSweep with sweeper belt

479BA022 KN

Specifications

Sweeping Attachments

KB-KM

Two roller brushes

Diameter: 250 mm

Working width: 600 mm

KW-KM

Two sweeping drums

Diameter: 270 mm

Working width: 600 mm

Weight

Complete with deflector and drive tube

KB-KM: 6.4 kg

KW-KM: 7.4 kg

Noise and Vibration Data

Noise and vibration measurements on power tools with KombiTools KB-KM and KW-KM include idling and racing in a ratio of 1:6.

For further details on compliance with Vibration Directive 2002/44/EC see www.stihl.com/vib.

Sound pressure level L_p to ISO 6081

KM 85 R with loop handle: 96 dB(A)

Sound pressure level L_p to ISO 11201

KM 55 R with loop handle: 96 dB(A)

KM 56 R with loop handle: 96 dB(A)

KM 90 R with loop handle: 92 dB(A)

KM 94 R with loop handle: 95 dB(A)

KM 100 R with loop handle: 90 dB(A)

KM 130 with loop handle: 99 dB(A)

Sound power level L_w to ISO 3744

KM 55 R with loop handle: 105 dB(A)

Sound power level L_w to ISO 3744

KM 56 R with loop handle: 106 dB(A)

KM 85 R with loop handle: 108 dB(A)

KM 90 R with loop handle: 102 dB(A)

KM 100 R with loop handle: 101 dB(A)

KM 130 R with loop handle: 106 dB(A)

Sound power level L_w to ISO 11201

KM 94 R with loop handle: 106 dB(A)

Vibration measurement $a_{hv,eq}$ to ISO 7916

| | | |
|--|--------------|---------------|
| | Handle, left | Handle, right |
|--|--------------|---------------|

KB-KM, KW-KM

| | | |
|---------------------------|----------------------|----------------------|
| KM 85 R with loop handle: | 3.8 m/s ² | 5.5 m/s ² |
|---------------------------|----------------------|----------------------|

Vibration measurement $a_{hv,eq}$ to ISO 20643

| | | |
|--|--------------|---------------|
| | Handle, left | Handle, right |
|--|--------------|---------------|

KB-KM

| | | |
|---------------------------|----------------------|----------------------|
| KM 55 R with loop handle: | 6.7 m/s ² | 8.2 m/s ² |
|---------------------------|----------------------|----------------------|

| | | |
|---------------------------|----------------------|----------------------|
| KM 56 R with loop handle: | 8.2 m/s ² | 8.2 m/s ² |
|---------------------------|----------------------|----------------------|

| | | |
|---------------------------|----------------------|----------------------|
| KM 90 R with loop handle: | 6.1 m/s ² | 4.1 m/s ² |
|---------------------------|----------------------|----------------------|

| | | |
|----------------------------|----------------------|----------------------|
| KM 100 R with loop handle: | 3.7 m/s ² | 6.6 m/s ² |
|----------------------------|----------------------|----------------------|

| | | |
|----------------------------|----------------------|----------------------|
| KM 130 R with loop handle: | 8.0 m/s ² | 8.6 m/s ² |
|----------------------------|----------------------|----------------------|

| | | |
|--|--------------|---------------|
| | Handle, left | Handle, right |
|--|--------------|---------------|

KW-KM

| | | |
|---------------------------|----------------------|----------------------|
| KM 55 R with loop handle: | 6.5 m/s ² | 7.0 m/s ² |
|---------------------------|----------------------|----------------------|

| | | |
|---------------------------|----------------------|----------------------|
| KM 56 R with loop handle: | 8.5 m/s ² | 7.5 m/s ² |
|---------------------------|----------------------|----------------------|

| | | |
|---------------------------|----------------------|----------------------|
| KM 90 R with loop handle: | 4.9 m/s ² | 7.0 m/s ² |
|---------------------------|----------------------|----------------------|

| | | |
|----------------------------|----------------------|----------------------|
| KM 100 R with loop handle: | 4.1 m/s ² | 6.5 m/s ² |
|----------------------------|----------------------|----------------------|

| | | |
|----------------------------|----------------------|----------------------|
| KM 130 R with loop handle: | 8.5 m/s ² | 9.4 m/s ² |
|----------------------------|----------------------|----------------------|

Vibration measurement $a_{hv,eq}$ to ISO 22867

| | | |
|--|--------------|---------------|
| | Handle, left | Handle, right |
|--|--------------|---------------|

KB-KM

| | | |
|---------------------------|----------------------|----------------------|
| KM 94 R with loop handle: | 4.5 m/s ² | 5.5 m/s ² |
|---------------------------|----------------------|----------------------|

| | | |
|--|-----------------|------------------|
| | Handle, left | Handle, right |
|--|-----------------|------------------|

KW-KM

KM 94 R with
loop handle:

| | |
|----------------------|----------------------|
| 4.6 m/s ² | 6.0 m/s ² |
|----------------------|----------------------|

The K-factor in accordance with Directive 2006/42/EC is 2.0 dB(A) for the sound pressure level and sound power level; the K-factor in accordance with Directive 2006/42/EC is 2.0 m/s² for the vibration level.

REACH

REACH is an EC regulation and stands for the Registration, Evaluation, Authorisation and Restriction of Chemical substances.

For information on compliance with the REACH regulation (EC) No. 1907/2006 see www.stihl.com/reach.

Maintenance and Repairs

Users of this machine may only carry out the maintenance and service work described in this user manual. All other repairs must be carried out by a servicing dealer.

STIHL recommends that you have servicing and repair work carried out exclusively by an authorized STIHL servicing dealer. STIHL dealers are regularly given the opportunity to attend training courses and are supplied with the necessary technical information.

When repairing the machine, only use replacement parts which have been approved by STIHL for this power tool or are technically identical. Only use high-quality replacement parts in order to avoid the risk of accidents and damage to the machine.

STIHL recommends the use of original STIHL replacement parts.

Original STIHL parts can be identified by the STIHL part number, the **STIHL** logo and the STIHL parts symbol  (the symbol may appear alone on small parts).

Disposal

Observe all country-specific waste disposal rules and regulations.

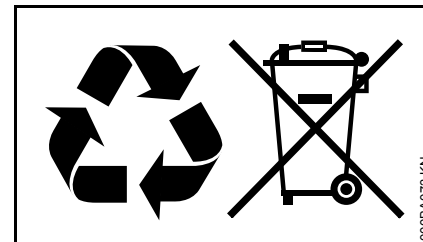

STIHL products must not be thrown in the garbage can. Take the product, accessories and packaging to an approved disposal site for environment-friendly recycling.

Contact your STIHL servicing dealer for the latest information on waste disposal.

EC Declaration of Conformity

ANDREAS STIHL AG & Co. KG

Badstr. 115

D-71336 Waiblingen

Germany

declare in exclusive responsibility that
the product

Category: Bristle
 Brush/Power-
 Sweep
 KombiTool

Make: STIHL

Model: KB-KM
 KW-KM

Serial identification: 4601

conforms to the relevant provisions of
Directive 2006/42/EC and has been
developed and manufactured in
compliance with the following standards
in the versions valid on the date of
production:

EN ISO 12100 (in conjunction with the
specified KM and FS-models).

Technical documents deposited at:

ANDREAS STIHL AG & Co. KG
Produktzulassung (Product Licensing)

The year of manufacture is applied to
the power tool.

Done at Waiblingen, 28.10.2016

ANDREAS STIHL AG & Co. KG



Thomas Elsner

Director Product Management and
Services



0458-479-0121-A

englisch



www.stihl.com



0458-479-0121-A